

Use and maintenance

Operating guidelines AS5160 series

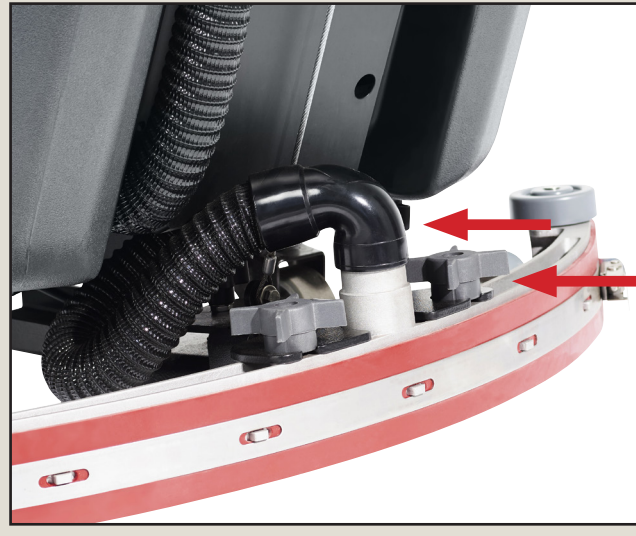

Turn on the key and verify there is enough battery power to complete the work. Charge batteries if required.



Install the squeegee using the thumb nuts. Attach squeegee hose.



Remove the red cover and fill the tank. Add appropriate low foaming detergent. Maximum tank capacity 16 Gallons / 61 liter.



Check the level of water with the red ball on the left side of the machine.



Disc version: place the brush/pad holder under the scrub deck then use the pedal to lower the deck over the brush. Press the OneTouch™ scrub button to enable scrubbing. The vacuum will start. Push on one of the two switches ½ second to install the brush.

Boost version: attach a pad to the fixed pad holder, press the OneTouch™ scrub button and the deck will lower automatically.

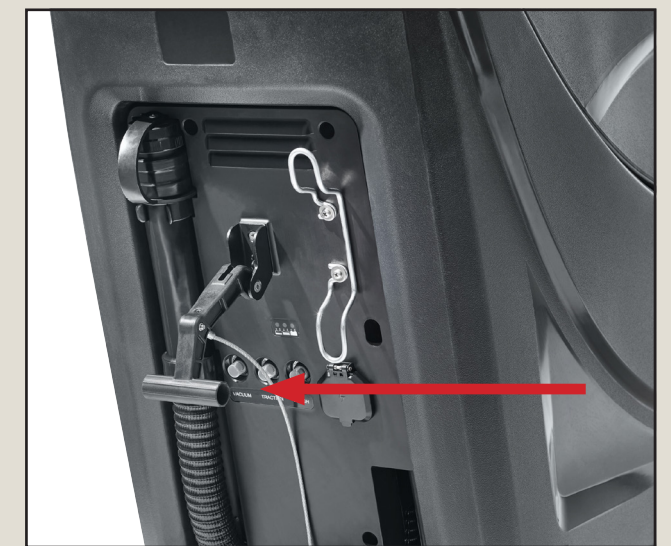

Use the handle to lower or raise the squeegee to the floor. Adjust the squeegee angle with the knob to adjust suction performance if needed.



Place the machine in working mode and press any of the two red safety switches to activate the machine.



For wheel traction version: use the rabbit / turtle knob to control the speed of the machine.



For wheel traction version: pressing either of the red safety switches and the black reverse button together will put the machine into reverse.



Press the + or – solution buttons to increase / decrease the water flow rate or to turn solution off.



BOOST version: Adjust scrub pressure when needed.



Push on the button



On disc version, the brush/pad holder can be removed automatically by raising the deck with the pedal and then press the click off button.

Maintenance

Operating guidelines AS5160 series



When scrubbing is complete, turn off the key to perform the following maintenance.



Daily: Empty the clean water tank using the solution tank drain knob under the machine.

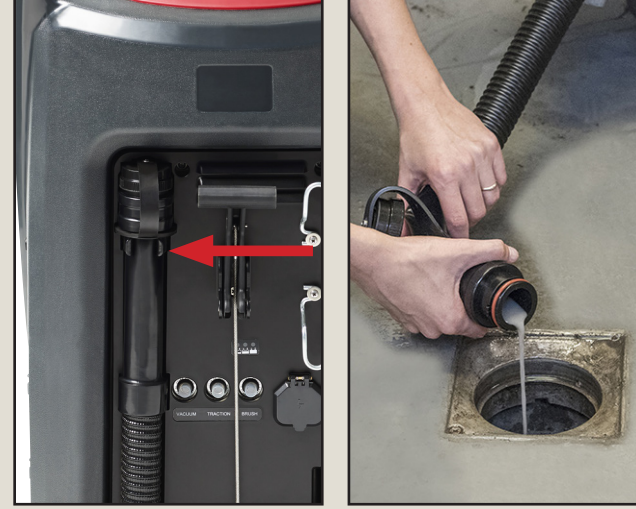

Daily: Empty the recovery tank using the recovery empty hose. Bend the soft part before removing the cap to control the flow.



Daily: Inspect and rinse the float ball cage and inspect and clean the lid gasket if required.

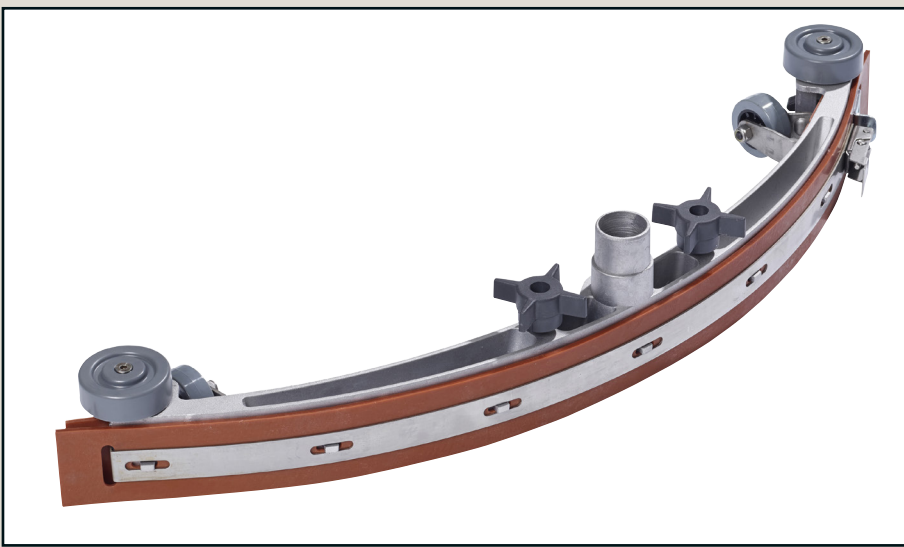

Daily: Remove the squeegee, and clean. Inspect the blades and flip them or replace them if required.

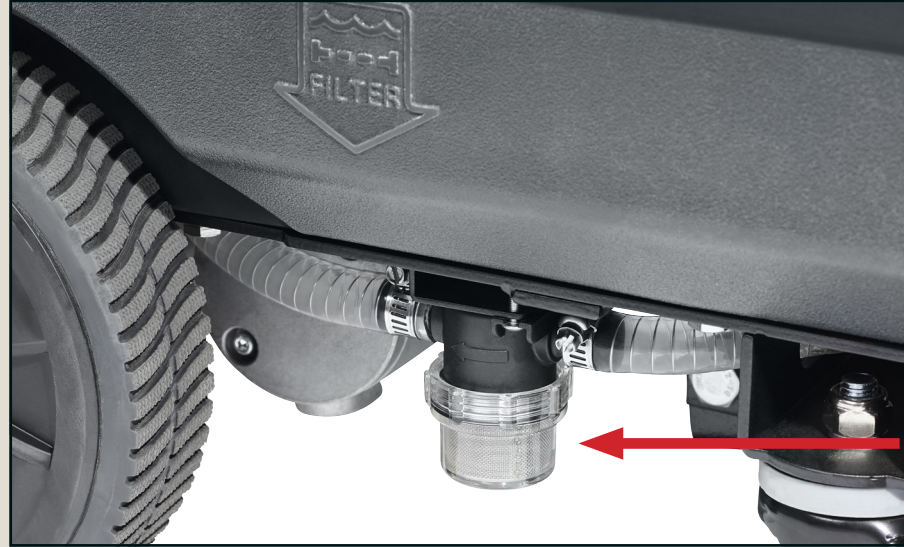

Weekly: Inspect the solution filter and clean if required.



Daily: Leave the recovery tank lid open after it's been cleaned to avoid bad odor.



Daily: to charge the battery, use the supplied AC cord to the on board charger and connect it to the machine and wall socket.

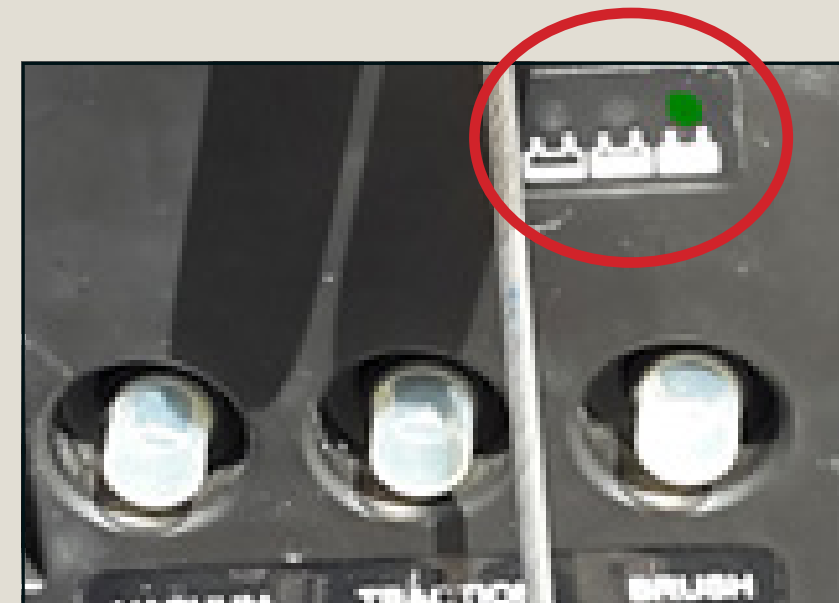
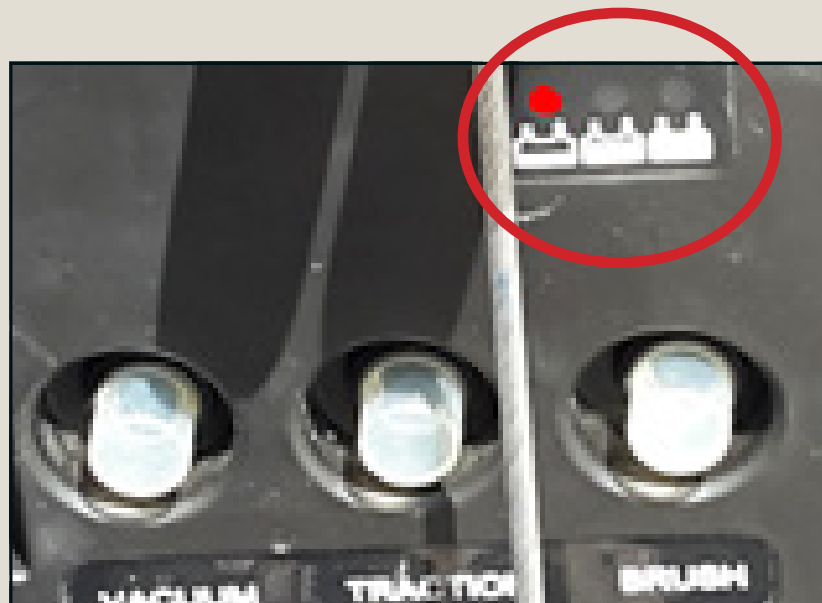

Daily: if the battery indicator shows red, put the machine on charge. Battery should be on charge if empty, not in use or if not being used for coming 8-10 hours.

Local Viper dealer: _____

Phone number: _____

SN: _____